



Instructions for Replacing Cartridge p/n U3003 in the Ultra-C™ 20 SCFM Filter

Caution: The dye in the cartridge is permanent. Avoid accidental contamination of other objects.

Instructions:

1. Two stage filters—turn off air supply and drain the filter. This will vent the filter of all compressed air.

Filters with indicator stage only—turn off air supply, vent the filter by opening downstream system to atmosphere.

2. Remove the bowl from the top of the filter by unscrewing it.
3. Remove the old cartridge by grasping it with a rag and pulling straight up with a slight twisting motion.
4. Any contamination of bowl or filter body should be cleaned away.
5. Install a new cartridge by pushing it straight down with a twisting motion, until it seats firmly. A small amount of vaseline or Neva-Stain on the o-ring may aid in installing the new cartridge.

Special Note—The bowl is o-ring sealed. Firm hand tightening is adequate.

6. Close all drains and vents, turn on air supply and the filter will start functioning immediately.

Caution: Polycarbonate bowls must be cleaned with soap and water only. Do not use volatile solvents.

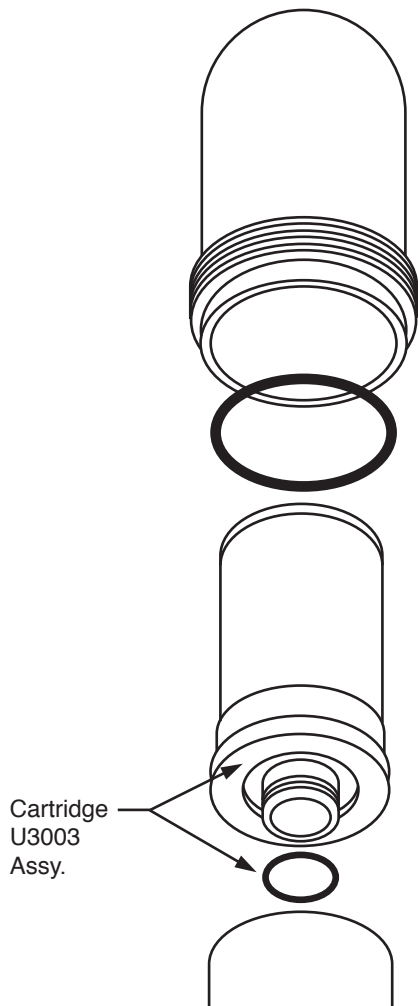

Instructions for Replacing Cartridge p/n U3003 in the Ultra-C™ 20 SCFM Filter

Caution: The dye in the cartridge is permanent. Avoid accidental contamination of other objects.

Instructions:

1. Two stage filters—turn off air supply and drain the filter. This will vent the filter of all compressed air.

Filters with indicator stage only—turn off air supply, vent the filter by opening downstream system to atmosphere.

2. Remove the bowl from the top of the filter by unscrewing it.
3. Remove the old cartridge by grasping it with a rag and pulling straight up with a slight twisting motion.
4. Any contamination of bowl or filter body should be cleaned away.
5. Install a new cartridge by pushing it straight down with a twisting motion, until it seats firmly. A small amount of vaseline or Neva-Stain on the o-ring may aid in installing the new cartridge.

Special Note—The bowl is o-ring sealed. Firm hand tightening is adequate.

6. Close all drains and vents, turn on air supply and the filter will start functioning immediately.

Caution: Polycarbonate bowls must be cleaned with soap and water only. Do not use volatile solvents.

